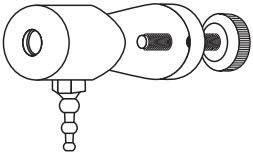
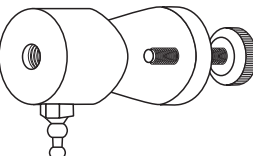
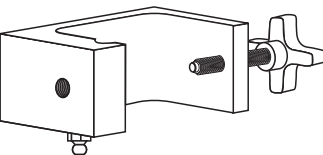
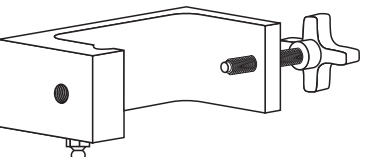
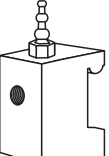

## E Cleaning Recommendations

1. Do not immerse gauge clamp in any liquid.
2. **Gauge Clamp Cleaning:** Wipe exterior of the gauge clamp with bactericidal or virucidal wipe.

## F Product Specifications

	<b>Model #</b>	<b>BE 148-5-1</b>
	<b>Type</b>	<b>Gauge Pole Clamp</b> — For 3/4" diameter poles
	<b>Use</b>	Reusable
	<b>Gauge Connection</b>	1/4" NPT
	<b>Tubing Connection</b>	Small Bore Tubing
	<b>Clamp Body Dimensions</b>	<b>Length</b> — 2.7 in. <b>Diameter</b> — 1.3 in.
	<b>Materials</b>	Anodized Aluminum
	<b>Packaged</b>	Individually
	<b>Model #</b>	<b>BE 148-5-2</b>
	<b>Type</b>	<b>Gauge Pole Clamp</b> — For 3/4" to 1 1/2" diameter poles
	<b>Use</b>	Reusable
	<b>Gauge Connection</b>	1/4" NPT
	<b>Tubing Connection</b>	Small Bore Tubing
	<b>Clamp Body Dimensions</b>	<b>Length</b> — 3.2 in. <b>Diameter</b> — 1.5 in.
	<b>Materials</b>	Anodized Aluminum
	<b>Packaged</b>	Individually
	<b>Model #</b>	<b>BE 148-5-2.5</b>
	<b>Type</b>	<b>Gauge Clamp</b> — For equipment requiring 1" to 2 1/2" opening
	<b>Use</b>	Reusable
	<b>Gauge Connection</b>	1/4" NPT
	<b>Tubing Connection</b>	Small Bore Tubing
	<b>Clamp Body Dimensions</b>	<b>Length</b> — 4.5 in. <b>Width</b> — 2.5 in. <b>Height</b> — 1.5 in.
	<b>Materials</b>	Anodized Aluminum
	<b>Packaged</b>	Individually
	<b>Model #</b>	<b>BE 148-5-3.5</b>
	<b>Type</b>	<b>Gauge Clamp</b> — For equipment requiring 2 1/2" to 3 1/2" opening
	<b>Use</b>	Reusable
	<b>Gauge Connection</b>	1/4" NPT
	<b>Tubing Connection</b>	Small Bore Tubing
	<b>Clamp Body Dimensions</b>	<b>Length</b> — 6 in. <b>Width</b> — 3 in. <b>Height</b> — 2 in.
	<b>Materials</b>	Anodized Aluminum
	<b>Packaged</b>	Individually
	<b>Model #</b>	<b>RB 004</b>
	<b>Type</b>	<b>Gauge Rail Clamp</b> — Mounts rear 1/4" NPT threaded gauges securely to Fairfield-style rails
	<b>Use</b>	Reusable
	<b>Gauge Connection</b>	1/4" NPT
	<b>Tubing Connection</b>	Small Bore Tubing
	<b>Clamp Body Dimensions</b>	<b>Length</b> — 1.5 in. <b>Width</b> — 1.5 in. <b>Height</b> — 2.6 in.
	<b>Materials</b>	Anodized Aluminum
	<b>Packaged</b>	Individually

### EXPLANATION OF SYMBOLS



Manufacturer



Non-Sterile

# Gauge Clamps

*Installation &  
Usage Directions*

**BE 148-5-1**  
**BE 148-5-2**  
**BE 148-5-2.5**  
**BE 148-5-3.5**  
**RB 004**

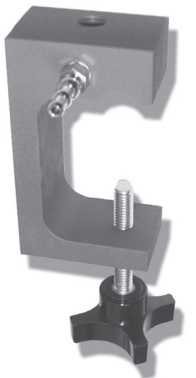

**Instrumentation**  
Industries, Inc.

2990 Industrial Blvd. • Bethel Park, PA 15102

US Toll Free: **1-800-633-8577**

Business: **1-412-854-1133**

US Toll Free Fax: **1-877-633-8661**

Fax: **1-412-854-5668**

E-mail: [sales@iiimedical.com](mailto:sales@iiimedical.com)

[www.iiimedical.com](http://www.iiimedical.com)

**Reusable**

— Not made with Natural Rubber Latex  
— Not made with Di(2-ethylhexyl) phthalate (DEHP)  
— Not made with Bisphenol A (BPA)



## A Product Description

Instrumentation Industries, Inc. **BE 148/RB 004 Series Gauge Clamps** are accessories to **NS Series Vacuum/Pressure Gauges** (*Airway Pressure Monitors*) which monitor patient airway pressure.

## B Notes

- **HANDLE** the gauge with care. Dropping or jarring the gauge will damage it.
- **ALWAYS** use a wrench to tighten a **Gauge** with a 1/4" NPT fitting into position.
- **NEVER** apply force on the gauge case to tighten into position.

## C 1/4" NPT Gauge Installation Directions

1. Prior to installation, at least **two layers of teflon tape** **MUST** be applied to threads of gauge fitting. **1**
2. Insert gauge into threaded hole of clamp. **2**
3. **HAND TIGHTEN** gauge. **3**
4. Place a **wrench** on the square fitting next to the gauge case and tighten. **4**

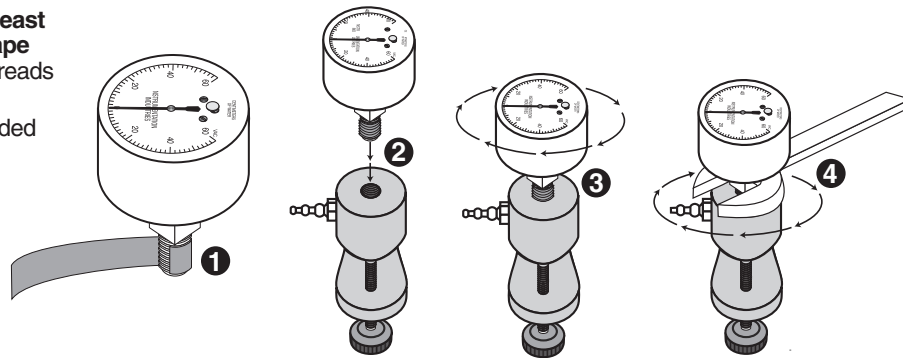

## D Directions for: Gauge Rail Clamp RB 004

1. Install Rear Mount 1/4" NPT **Vacuum/Pressure Gauge** into **Gauge Clamp**. (see instructions in panel C.) **1**
2. Mount **Clamp with Installed Gauge** to **Fairfield-style Rail**. **2**
3. Tighten **Clamp with Installed Gauge** by turning **Screw Knob**. **3**
4. Attach a length of **Small Bore Tubing** to **Small Bore Tubing Bubble Connection**. **4**
5. Attach other end of **Small Bore Tubing** to **Pressure Adapter**. **5**

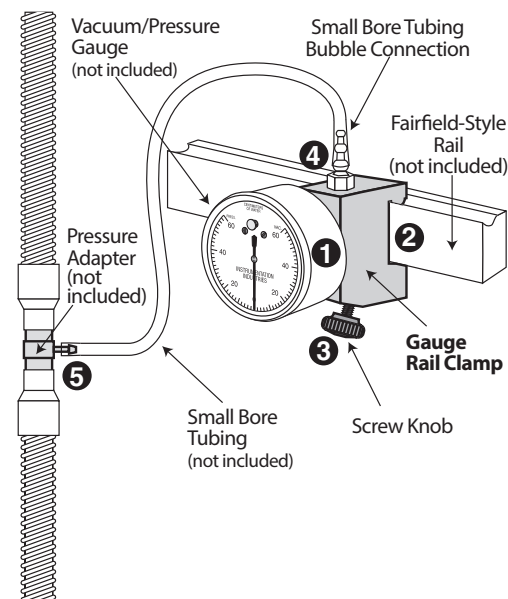

## E Directions for: Gauge Clamps BE 148-5-1 — BE 148-5-2

1. Install Rear Mount 1/4" NPT **Vacuum/Pressure Gauge** into **Gauge Clamp**. (see instructions in panel C.) **1**
2. Mount **Clamp with Installed Gauge** to Pole. **2**
3. Tighten **Clamp with Installed Gauge** by turning **Screw Knob**. **3**
4. Attach a length of **Small Bore Tubing** to **Small Bore Tubing Bubble Connection**. **4**
5. Attach other end of **Small Bore Tubing** to **Pressure Adapter**. **5**

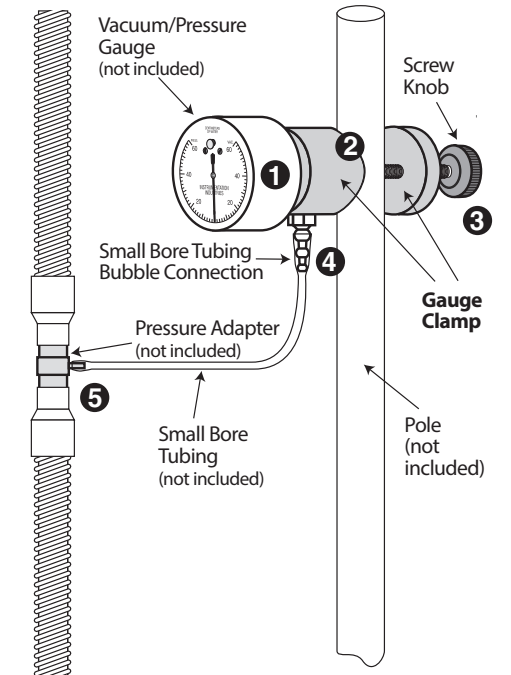

## F Directions for: Gauge Clamps BE 148-5-2.5 — BE 148-5-3.5

1. Install Rear Mount 1/4" NPT **Vacuum/Pressure Gauge** into **Gauge Clamp**. (see instructions in panel C.) **1**
2. Mount **Clamp with Installed Gauge** to Pole/Equipment. **2**
3. Tighten **Clamp with Installed Gauge** by turning **Screw Knob**. **3**
4. Attach a length of **Small Bore Tubing** to **Small Bore Tubing Bubble Connection**. **4**
5. Attach other end of **Small Bore Tubing** to **Pressure Adapter**. **5**

